

GENERAL NOTE

ALL DIMENSIONS RELEVANT TO SETTING OUT AND OFF-SITE WORK SHALL BE VERIFIED BY THE CONTRACTOR BEFORE CONSTRUCTION AND/OR FABRICATION IS COMMENCED. DRAWINGS SHALL NOT BE SCALED UNLESS SPECIFICALLY NOTED OTHERWISE.

WORKMANSHIP AND MATERIALS ARE TO BE IN ACCORDANCE WITH THE REQUIREMENTS OF THE RELEVANT CURRENT SAA CODES (INCLUDING ALL AMENDMENTS), AND LOCAL & STATUTORY AUTHORITIES, EXCEPT WHERE VARYED BY THE CONTRACT DOCUMENTS.

ALL FRAMING, TE-DOWN DETAILS & BRACING TO COMPLY WITH THE FRAME MAKER'S DETAILS & SPECIFICATION & AS 3623 - Domestic Metal Framing Code

HOLD DOWN DETAILS ARE NOT SUITABLE FOR LOOSE SAND OR SOFT TO FIRM CLAY REFER TO STRUCTURAL ENGINEER IF NECESSARY

SAFETY REQUIREMENTS SHALL BE IN ACCORDANCE WITH THE RELEVANT HEALTH AND SAFETY ACT AS ADMINISTERED BY THE DIVISION OF ACCIDENT PREVENTION

ALL DIMENSIONS ARE IN MILLIMETRES UNLESS NOTED OTHERWISE

ALL PLANS REMAIN THE PROPERTY OF
Taylor Made Buildings Pty Ltd

REV DATE DETAILS



2R Clarendon Road, North Dulwich NSW 2830 Tel 02 8882 6066 Fax 02 8882 0155 Facebook 1800 628 040 Email - admin@taylormadebuildings.com.au

Noble 8 Bay Mod.

166.99 sq.m.

TITLE

DATE

JOB No.

REV.

REF.

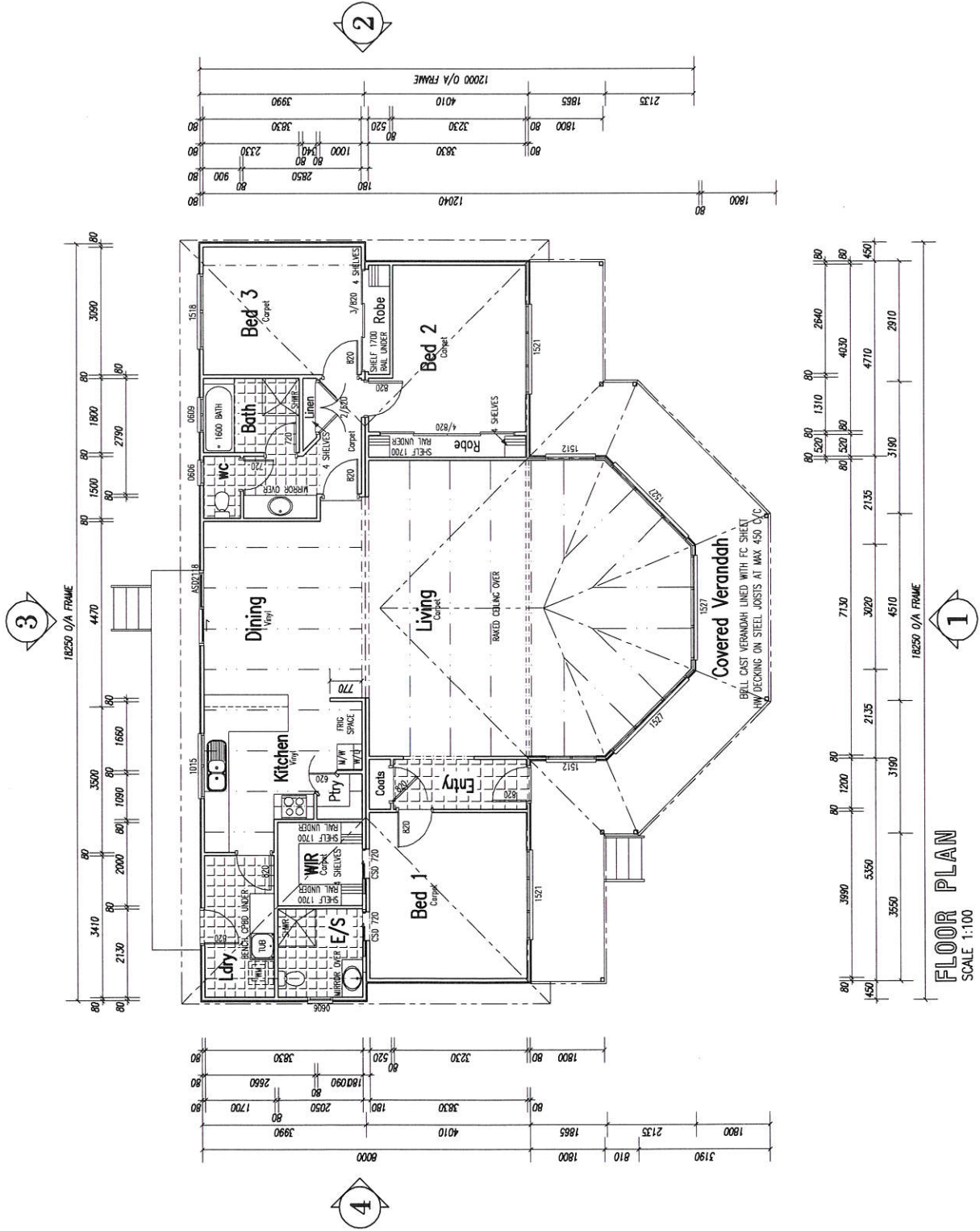

FLOOR PLAN
SCALE 1:100

